

WM NEVIN

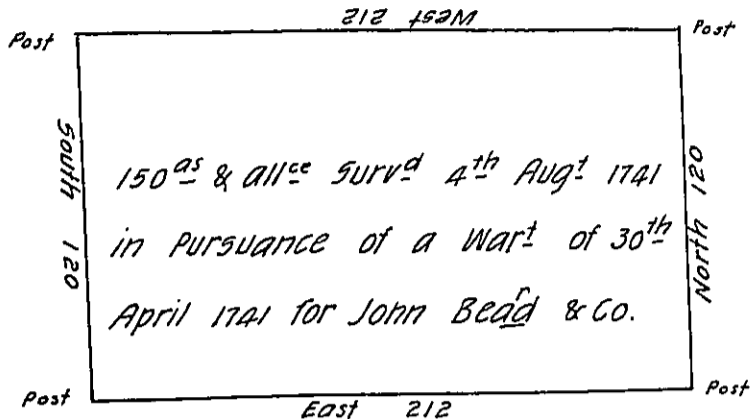

Land of the London Company

John Todd his Land

150 aces & c. surveyed to John Beard being part of W^t dated as above inserted

For original survey see Patented Files 8th June 1743. Letter N.

IN TESTIMONY that the above is a copy of the original remaining on file in the Department of Internal Affairs of Pennsylvania, made conformably to an Act of Assembly approved the 16th day of February, 1833, I have hereunto set my Hand and caused the Seal of said Department to be affixed at Harrisburg, this twenty third day of February 1906

Francis Brown
Secretary of Internal Affairs.